

Kit 1620

FORD Focus, 4-dr Sedan, *08-11

*North America

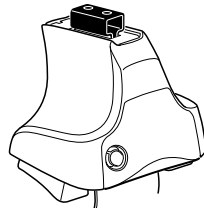

480R Rapid Traverse
754 Rapid System

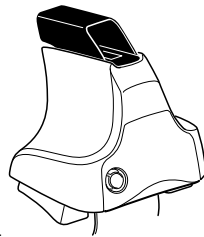
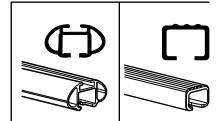

480 Traverse

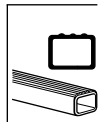

1

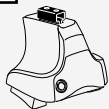

480R Rapid Traverse
754 Rapid System



480 Traverse

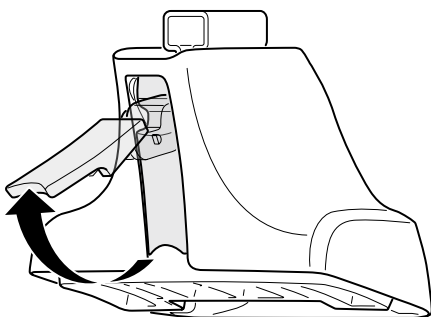

2



480R Rapid Traverse
754 Rapid System



480 Traverse

+

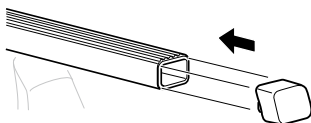
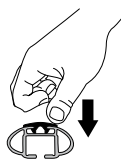
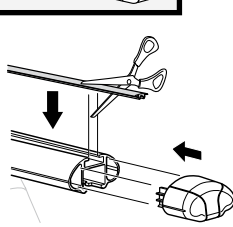
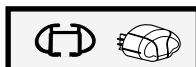
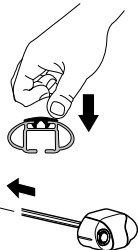
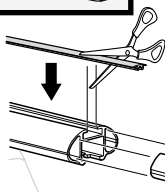
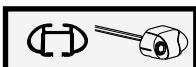
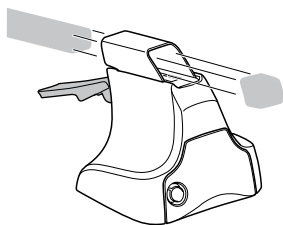
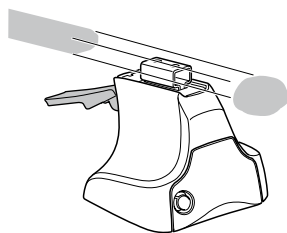

3

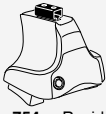

754 Rapid System

1

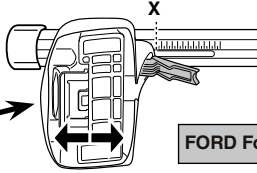
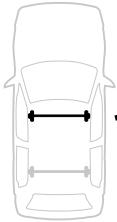

2

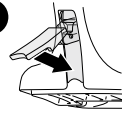

FORD Focus, 4-dr Sedan, *08-11

X

24

1

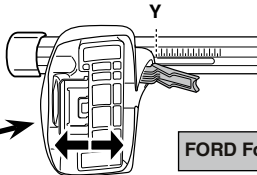
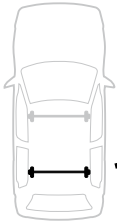

2

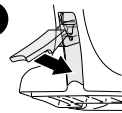

FORD Focus, 4-dr Sedan, *08-11

Y

22,5

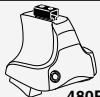

480R Rapid Traverse



480 Traverse

1

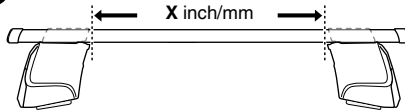

2

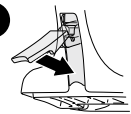

FORD Focus, 4-dr Sedan, *08-11

X inch

X mm

35 1/8"

891 mm

1

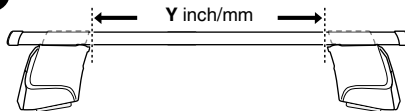

2

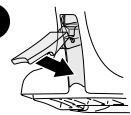

FORD Focus, 4-dr Sedan, *08-11

Y inch

Y mm

34 1/2"

876 mm

4



480R Rapid Traverse
754 Rapid System



480 Traverse

FORD Focus, 4-dr Sedan, *08-11

204



365



206

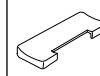

365



206



546



204

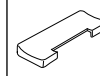

546

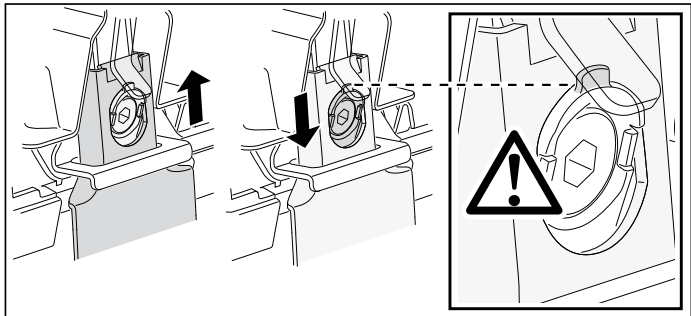
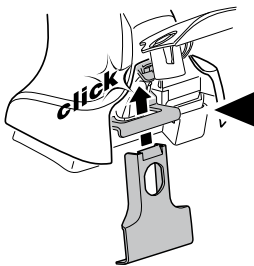
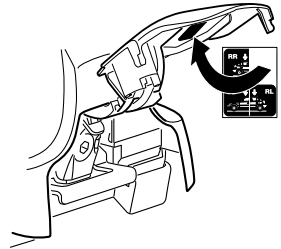
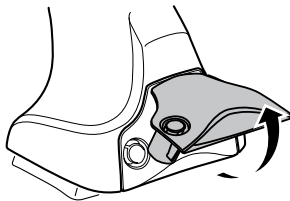
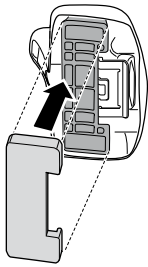
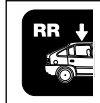

5



	X mm	Y mm	X inch	Y inch
FORD Focus, 4-dr Sedan, *08-11	255 mm	650 mm	10"	25 1/2"

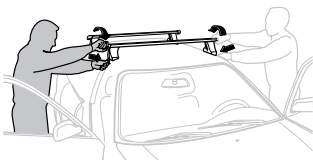
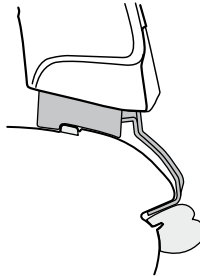
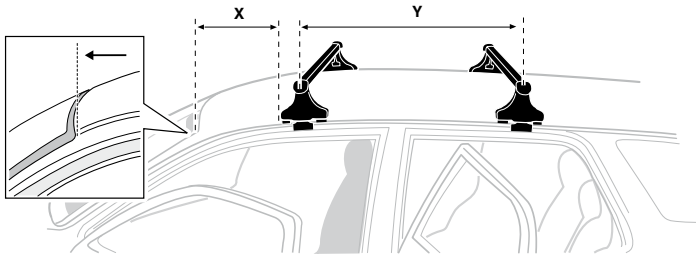

- | | | | |
|--------------|---|------------|---|
| GB/US | Tighten alternately | CZ | Pokreťta bagazníka dokrečaj dokrečaj naprzemiennie. |
| D | Die Schrauben abwechselnd anziehen | SK | Dofahujte striedavo |
| F | Serrer alternativement chaque côté | SLO | Privijajte izmenično. |
| NL | Afwisselend aan de linker- en de rechterkant aandraaien | HR | Naizmjenično zategnite |
| I | Alternare il serraggio delle viti | HU | Egymástól függetlenül szorítandó |
| E | Apretar alternativamente | GR | Σφιγγετε εναλλάξ |
| PT | Aperte alternadamente | TR | Dönüşümlü sıkın |
| S | Dra åt växelvis | 中文 | 交替拧紧 |
| FIN | Kierrä vuorotellen | 한국어 | 번갈아 가며 조이십시오. |
| EST | Pinguldage vaheldumisi | 日本語 | 交互に締め付けてください。 |
| LAT | Pievēlciet pamāšus | ไทย | ขันในแบบสลับ |
| LIT | Užsukinkite pakaitomis | | |
| PL | Śruby dokreçaj naprzemiennie | | |
| RU | Затягивайте попеременно | | |

6

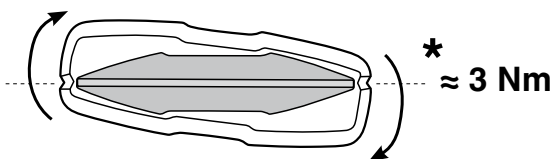
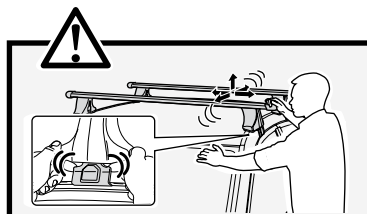
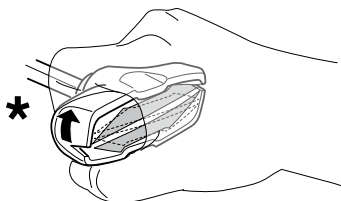
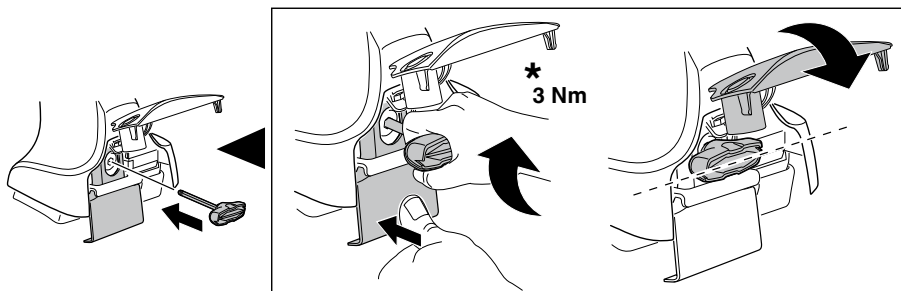
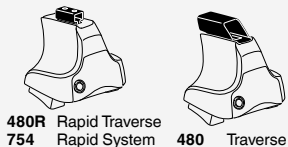

7

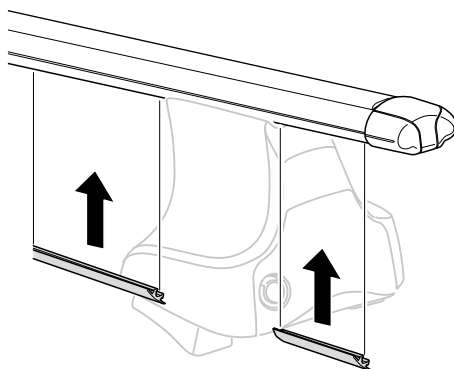
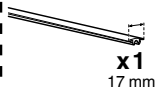

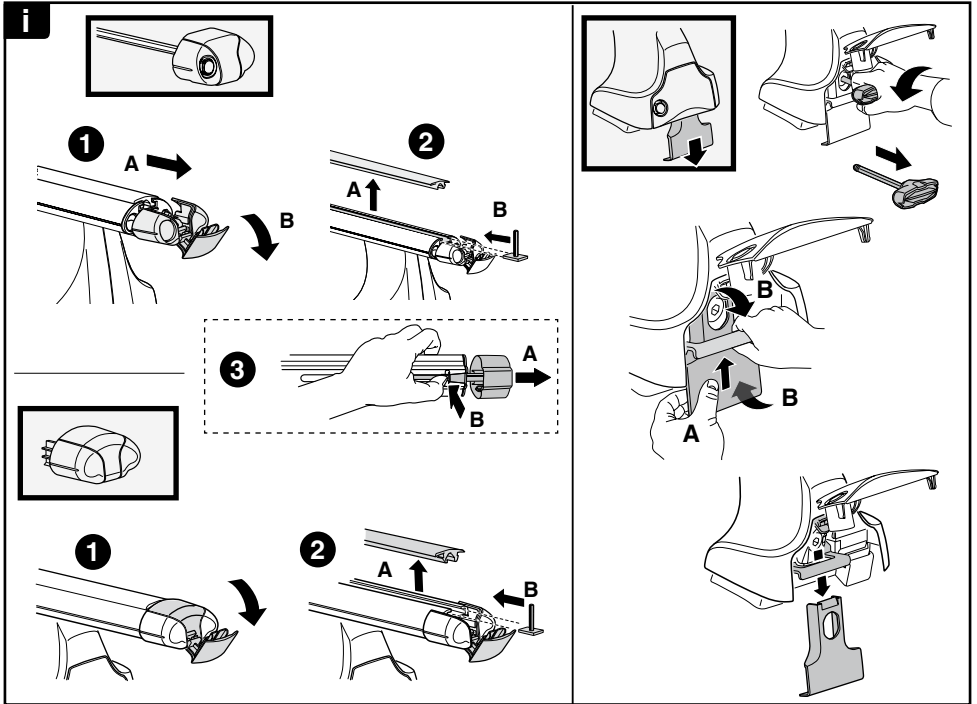
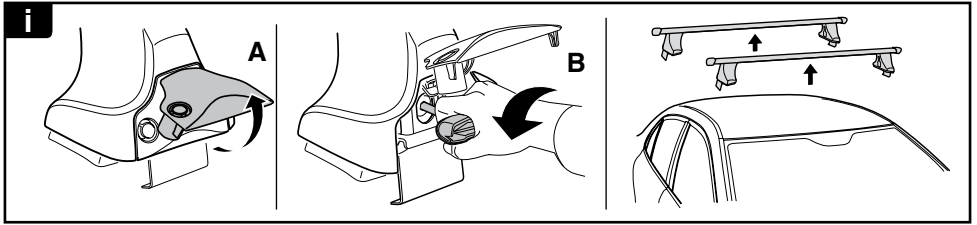

THULE
SWEDEN

**ONE
KEY
SYSTEM**

544 (x4)

596 (x6)

588 (x8)

NA 510 (x10)

EUR 452 (x12)

ASIA